

The product using material and processing must conform to the "WI-PZ-001" HSF technical standard control requirements



RoHS+HF

- NOTE:
- MATERIAL SPECIFICATION:
    - 1-1.HOUSING: LCP,UL94V-0
    - 1-2.CONTACTS: PHOSPHOR BRONZE
  - PLATING SPECIFICATION:
    - 2-1.CONTACTS: TIN/GOLD FLASH PLATED OVER ALL.
  - ELECTRICAL PERFORMANCE:
    - 3-1.CURRENT RATING: 3A AC/DC
    - 3-2.CONTACT RESISTANCE: 20 mΩ MAX
    - 3-3.INSULATION RESISTANCE: 1000MΩ Min
    - 3-4.DIELECTRIC WITHSTANDING : 500V
  - ENVIRONMENTAL PERFORMANCE:
    - 4-1.OPERATING TEMPERATURE: -25°C~+85°C.
  - PACKAGE SPEC: REEL
  - P/N:

△ A1

SERIES NO: A1502 W 9 1-1 XX 2 X X 1

CONNECTOR: W-WAFER

ANGLE: 9-90°

TYPE: 1-TYPE 1

ROW NO: 1-SINGLE ROW

COLOR: A-BLACK S-NATURE

PLATING: A-ALL AU G/F C-BRIGHE TIN D-MATTE Tin

TERMIPOINT: 2-SMT

PIN Q'PY: 02~15

Circuit	Dimensions(mm)			Circuit	Dimensions(mm)		
	A	B	C		A	B	C
02	1.50	4.30	3.70	09	12.00	14.80	14.20
03	3.00	5.80	5.20	10	13.50	16.30	15.70
04	4.50	7.30	6.70	11	15.00	17.80	17.20
05	6.00	8.80	8.20	12	16.50	19.30	18.70
06	7.50	10.30	9.70	13	18.00	20.80	20.20
07	9.00	11.80	11.20	14	19.50	22.30	21.70
08	10.50	13.30	12.70	15	21.00	23.80	23.20

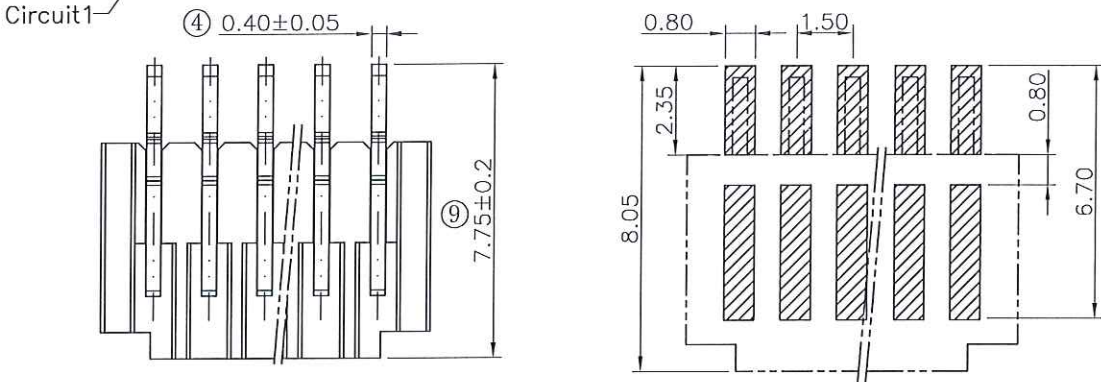

RECOMMENDED PCB LAYOUT  
(GENERAL TOLERANCE:±0.05)

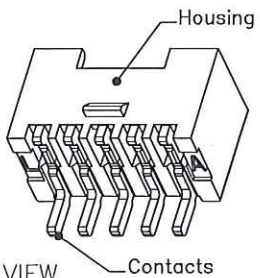
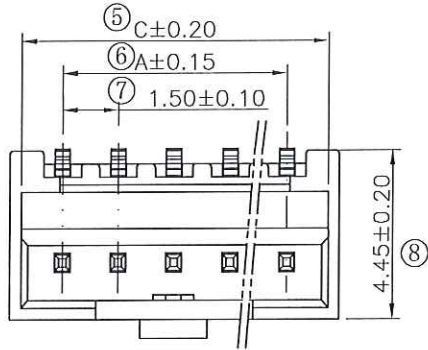

REV.	REVISION RECORD	DATE	GENERAL TOLERANCES	SCALE: 1:1	NAME	DATE	PART.NO:	DWG.NO:
A0	NEW RELEASE	22.07.07	LINEAR	APPROVED	8/8/24	2024.6.25	A1502W91-1XX2XX1	ENDE05
A1	PART NUMBER RENEWAL		0.0±0.35	DESIGNER	梁林根	2024.6.25	TITLE:	WanLian Technology Co., Ltd
			0.00±0.25	DRAWN	肖雨晴	2024.6.25	Pitch 1.50mm 90°单排卧贴带扣 Wafer	REV: A1
			0.000±0.10					SHEET: 1/2

The product using material and processing must conform to the "WI-PZ-001"HSF technical standard control requirements

RoHS+HF

产品引出方向

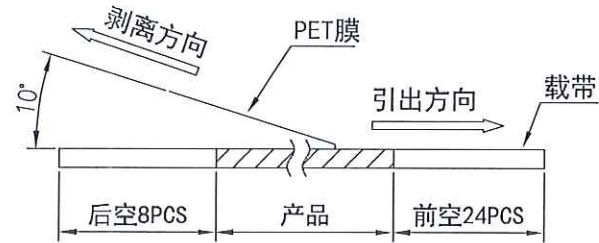
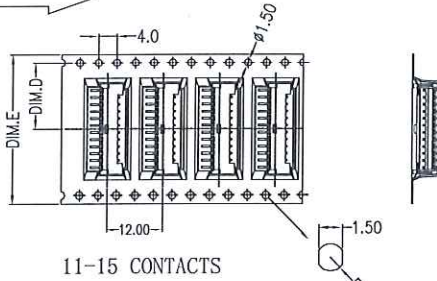
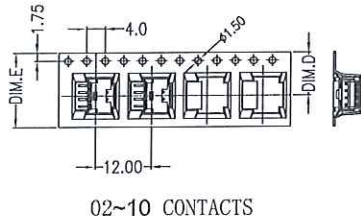

(PET膜剥离示意图)

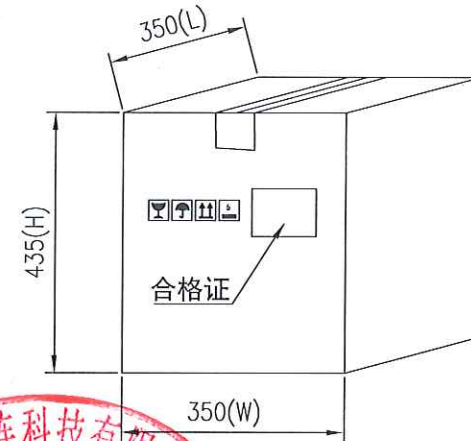
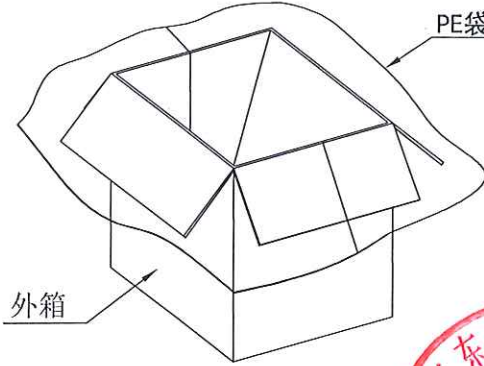
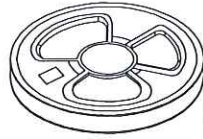
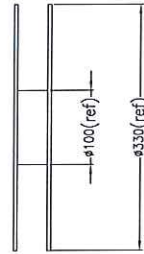
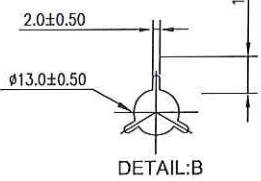
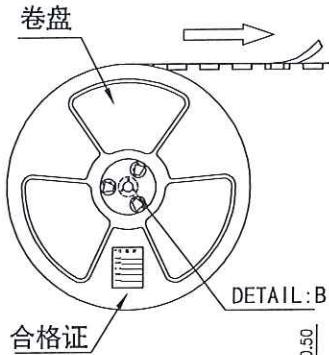

列表一

Circuits	DIM. D	DIM. E	Q'ty/Reel	Packing (Reel/Caton)
02~04PIN	7.5	16	1000PCS	20/Reel
05~10PIN	11.50	24	1000PCS	15/Reel
11~13PIN	14.20	32	1000PCS	11/Reel
14~15PIN	20.20	44	1000PCS	8/Reel

包装说明:

- 把成品包入卷盘中, 每盘装1000PCS, 卷盘上贴上合格证, 将装好产品的卷盘放进外箱中, 外箱内先套一个大PE袋, 外箱上贴贴合格证。
- 所有材料有害物控制需符合RoHS标准。



REV.	REVISION RECORD	DATE	UNIT:mm	GENERAL TOLERANCES	SCALE: 1:1	NAME	DATE	PART.NO:	DWG.NO:	
A0	NEW RELEASE	22.07.07	A4	LINEAR	APPROVED	梁科积	2024.5.15	A1502W91-1XX2XX1	ENDE05	
A1	PART NUMBER RENEWAL			0.0±0.35						X'REF±6'
				0.00±0.25		梁科积	2024.6.25	Pitch 1.50mm 90°单排贴片带扣 Wafer 包装规范		
				0.000±0.10		肖雨曦	2024.6.25			