

The product using material and processing must conform to the "WI-PZ-142"HSF technical standard control requirements

RoHS

NOTE:
 1.MATERIAL SPECIFICATION:
 1-1.TERMINAL:COPPER ALLOY BRASS
 2.PLATING SPECIFICATION:
 2-1.TERMINAL:
 TIN/AU PLATED OVER ALL.
 3.ELECTRICAL PERFORMANCE:
 3-1. RATED CURRENT : 3A AC,DC
 3-2.INSULATION RESISTANCE: 1000MΩ MIN
 3-3.CONTACT RESISTANCE : 20mΩ(MAX.)
 3-4.WITHSTANDING VOLTAGE: 500V AC/minute
 4.ENVIRONMENTAL PERFORMANCE:
 OPERATING TEMPERATURE: -25°C~+85°C.

SERIES NO: A1502 T F X-X
 CONNECTOR: T-TERMINAL
 MALE FEMALE:
 PLATING:
 1-G/F
 A-ALL AU G/F
 C-BRIGHT TIN
 D-MATTE TIN
 METAL:
 P-PHOSPHOR BRONZE
 B-BRASS

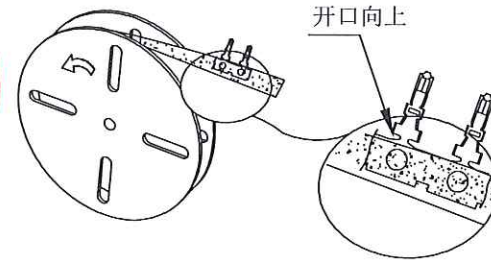
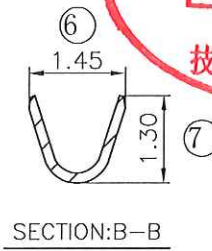
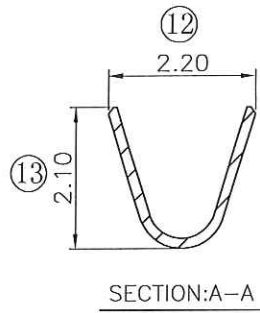
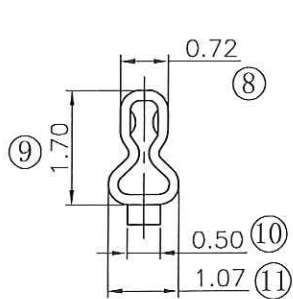
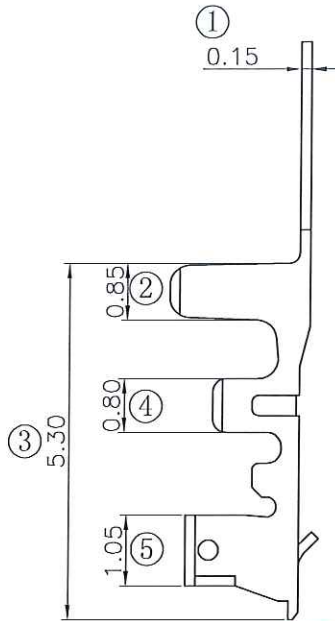
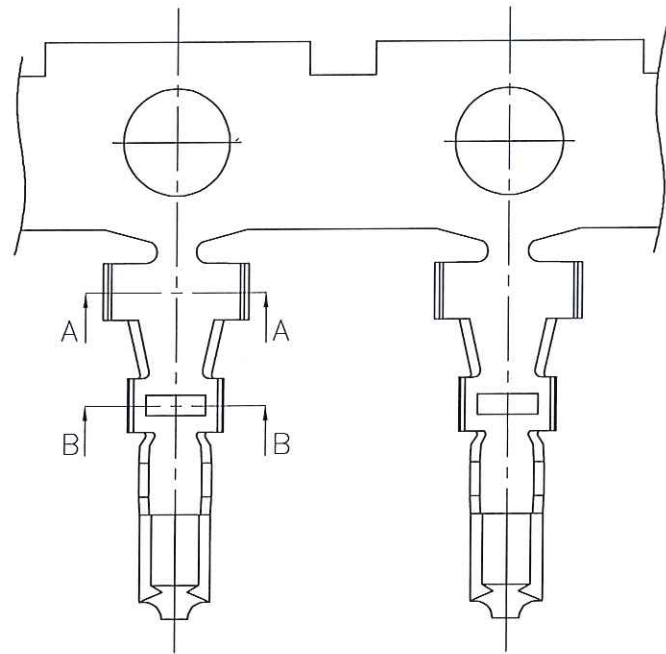

Ordering Information & Specifications

Wire Range	Insulation O.D.	Qty/reel
AWG#24-#28	1.10mm(max)	10,000pcs

REV.	REVISION RECORD	DATE	GENERAL TOLERANCES	SCALE:	NAME	DATE	PART.NO:	DWG.NO:								
A0	NEW RELEASE		<table border="1"> <tr> <td>LINEAR</td> <td>0.0±0.35</td> </tr> <tr> <td>ANGLES</td> <td>X'REF±6'</td> </tr> <tr> <td></td> <td>X'±3'</td> </tr> <tr> <td></td> <td>X'X' ±2'</td> </tr> </table>	LINEAR	0.0±0.35	ANGLES	X'REF±6'			X'±3'		X'X' ±2'	1:1	梁材秋	2024.6.25	A1502TFX-X
LINEAR	0.0±0.35															
ANGLES	X'REF±6'															
	X'±3'															
	X'X' ±2'															
			<table border="1"> <tr> <td>UNIT:mm</td> <td>0.00±0.25</td> </tr> <tr> <td>SIZE: A4</td> <td>0.000±0.10</td> </tr> </table>	UNIT:mm	0.00±0.25	SIZE: A4	0.000±0.10	APPROVED	梁材秋	2024.6.25	TITLE: 1.50mm PITCH CRIMP TERMINAL		REV: A0	SHEET: 1/1		
UNIT:mm	0.00±0.25															
SIZE: A4	0.000±0.10															
				DESIGNER	梁材秋	2024.6.25										
				DRAWN	梁材秋	2024.6.25										