

The product using material and processing must conform to the "WI-PZ-001"HSF technical standard control requirements

RoHS



NOTE:  
 1.MATERIAL SPECIFICATION:  
 1-1.TERMINAL: PHOSPHOR BRONZE  
 2.PLATING SPECIFICATION:  
 2-1.TERMINAL:  
 TIN/GOLD FLASH PLATED  
 3.ELECTRICAL PERFORMANCE:  
 3-1.CURRENT RATING: 1A AC/DC  
 3-2.CONTACT RESISTANCE: 30 mΩ MAX  
 3-3.INSULATION RESISTANCE: 100MΩ Min  
 3-4.DIELECTRIC WITHSTANDING : 500V  
 4.ENVIRONMENTAL PERFORMANCE:  
 4-1.OPERATING TEMPERATURE: -25°C~+85°C.  
 5.PACKAGE SPEC: REEL  
 6.P/N:

SERIES NO: A1257 T F X-X  
 CONNECTOR: T-TERMINAL  
 MALE FEMALE: F-FEMALE  
 PLATING:  
 1-G/F  
 A-ALL AU G/F  
 C-BRIGHT TIN  
 D-MATTE TIN  
 METAL:  
 P-PHOSPHOR BRONZE  
 B-BRASS

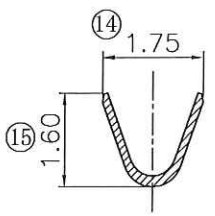
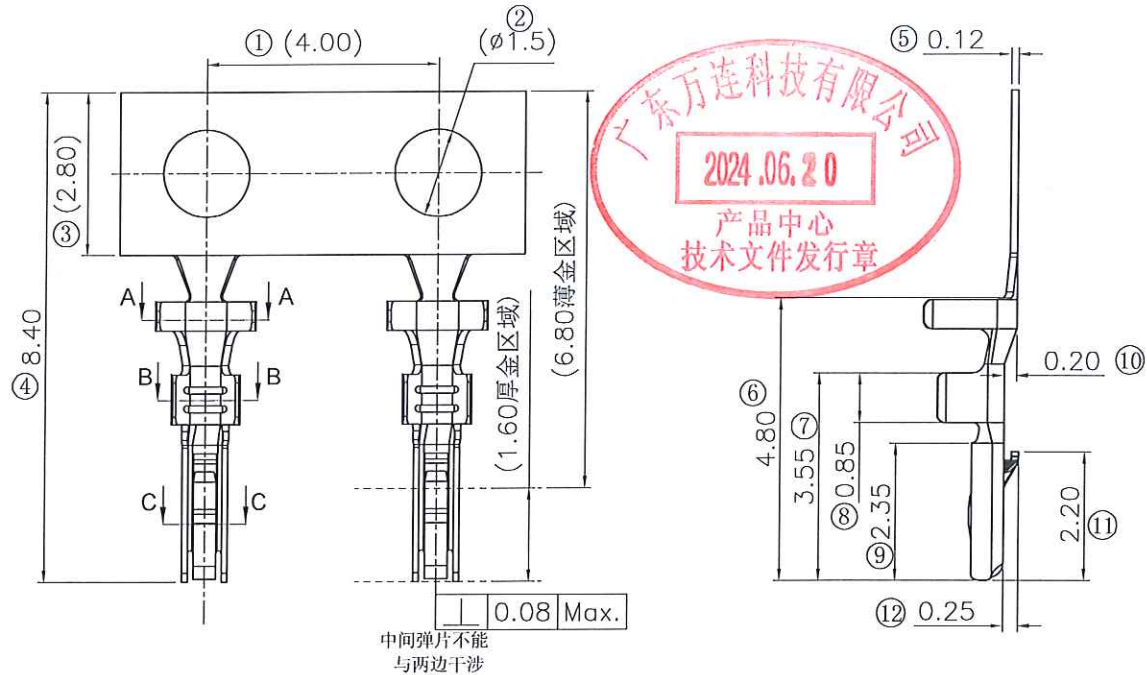

SECTION:A-A

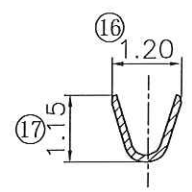

SECTION:B-B

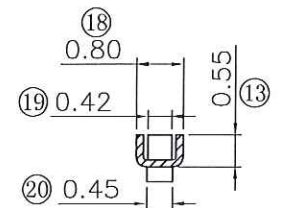

SECTION:C-C

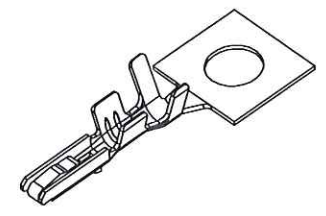

3D VIEW

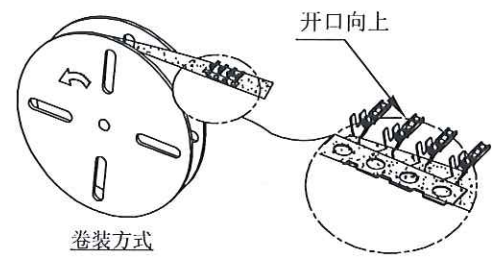

Ordering Information & Specifications

Wire Range	Insulation O.D.	Qty/reel
AWG#26-#30	1.00mm(max)	15,000pcs

REV.	REVISION RECORD	DATE	UNIT: mm	GENERAL TOLERANCES	SCALE: 1:1	NAME	DATE	PART.NO:	DWG.NO:	 WanLian Technology Co., Ltd
A0	NEW RELEASE			LINEAR 0.0±0.35	APPROVED	马学洋	2024.6.20	A1257TFX-X	ENDE05	
				ANGLES X'REF±6'	DESIGNER	梁林秋	2024.6.20	TITLE: Pitch 1.25mm GH端子 AWG#26~#30		REV: A0
			SIZE: A4	0.00±0.25 X'±3'	DRAWN	肖雨曦	2024.6.20			SHEET: 1/1
				0.00±0.10 X'X' ±2'						