

The product using material and processing must conform to the "WI-PZ-001" HSF technical standard control requirements

RoHS+HF

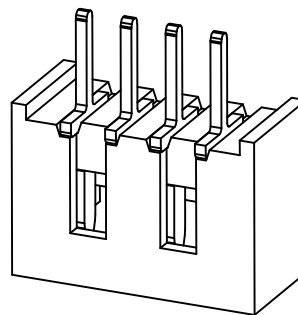
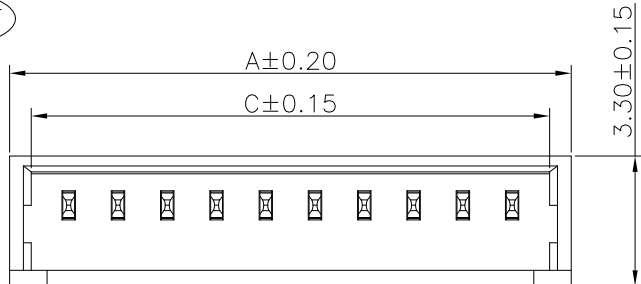

3D VIEW

NOTE:

- 1.MATERIAL SPECIFICATION:
  - 1-1.HOUSING: LCP,UL94V-0
  - 1-2.CONTACTS: BRASS
- 2.PLATING SPECIFICATION:
  - 2-1.CONTACTS: TIN/GOLD FLASH PLATED OVER ALL.
- 3.MECHANICAL PERFORMANCE:
  - 3-1.RETENTIVITY FORCE: 0.7KGF/pin min
  - 3-2.DURABILITY: 50 CYCLES.
- 4.ELECTRICAL PERFORMANCE:
  - 4-1.CURRENT RATING: 1A AC/DC
  - RATED VOLTAGE : 125V AC/DC
  - 4-2.CONTACT RESISTANCE: 30 mΩ MAX
  - 4-3.INSULATION RESISTANCE: 100MΩ Min
  - 4-4.DIELECTRIC WITHSTANDING : 500V
- 5.ENVIRONMENTAL PERFORMANCE:
  - 5-1.OPERATING TEMPERATURE: -25°C~+85°C.
- 6.PACKAGE SPEC: PE BAG
- 7.P/N:



A1251 W 0 1-1 XX 1 X X 0

SERIES NO: \_\_\_\_\_

CONNECTOR: \_\_\_\_\_

ANGLE: \_\_\_\_\_

TYPE: \_\_\_\_\_

ROW NO: \_\_\_\_\_

PIN Q'PY: \_\_\_\_\_

COLOR: A-BLACK M-BEIGE

PLATING: A-ALL AU G/F C-BRIGHT TIN D-MATTE TIN

TERMIPOINT: 1-DIP

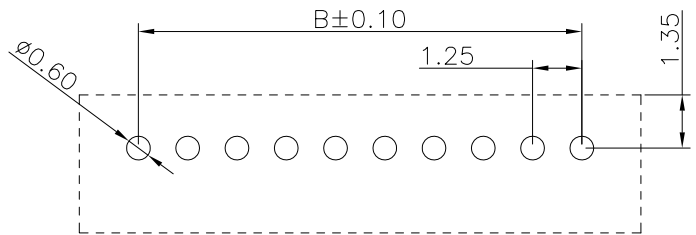
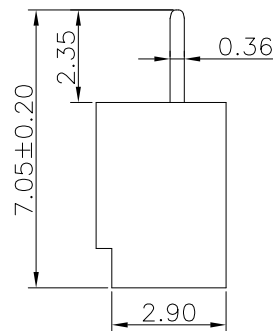
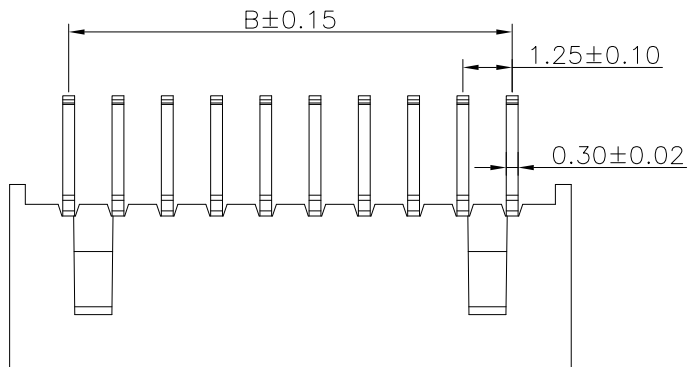

PCB Layout

Ordering Information & Dimensions

Poles	Dimensions(mm)			Poles	Dimensions(mm)		
	A	B	C		A	B	C
02	4.20	---	3.10	10	14.20	11.25	13.10
03	5.45	2.50	4.35	11	15.45	12.50	14.35
04	6.70	3.75	5.60	12	16.70	13.75	15.60
05	7.95	5.00	6.85	13	17.95	15.00	16.85
06	9.20	6.25	8.10	14	19.20	16.25	18.10
07	10.45	7.50	9.35	15	20.45	17.50	19.35
08	11.70	8.75	10.60	16	21.70	18.75	20.60
09	12.95	10.00	11.85				

REV.	REVISION RECORD	DATE	UNIT:mm	GENERAL TOLERANCES		SCALE:	NAME	DATE	PART.NO:	DWG.NO:	TITLE:	REV: A1	SHEET: 1/1
A0	NEW RELEASE	21.11.17		LINEAR	ANGLES	1:1							
A1	PART NUMBER RENEWAL	23.9.14	0.00±0.25	X°±3°	DESIGNER	Han_Gao	23.9.14	A1251W01-1XX1XX0	ENDE05	Pitch 1.25mm 180° 单排闭口立插 Wafer	WanLian Technology Co., Ltd		
			0.00±0.10	X°X' ±2°	DRAWN	Zijun_Huang	23.9.14						



WanLian Technology Co., Ltd