

The product using material and processing must conform to the "WI-PZ-142"HSF technical standard control requirements

RoHS+HF

NOTE:
 1.MATERIAL SPECIFICATION:
 1-1.HOUSING:LCP, UL94V-0
 1-2.SOLDERING LUG:PHOSPHOR BRONZE
 1-3.CONTACTS:PHOSPHOR BRONZE
 1-4.CAP:LCP, UL94V-0
 2.PLATING SPECIFICATION:
 2-1.CONTACTS:
 TIN/AU PLATED OVER ALL.
 3.ELECTRICAL PERFORMANCE:
 3-1. RATED CURRENT : 1A AC,DC
 3-2.INSULATION RESISTANCE: 100MΩ MIN
 3-3.CONTACT RESISTANCE : 20mΩ(MAX.)
 3-4.WITHSTANDING VOLTAGE: 500V AC/minute
 5.ENVIRONMENTAL PERFORMANCE:
 OPERATING TEMPERATURE: -25°C~+85°C.
 6.PACKAGE SPEC. REEL
 7.P/N:

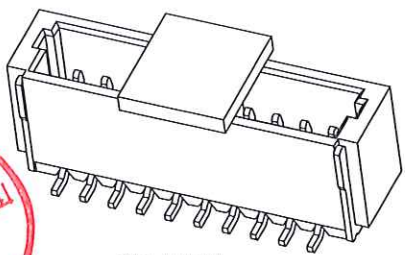

3D VIEW

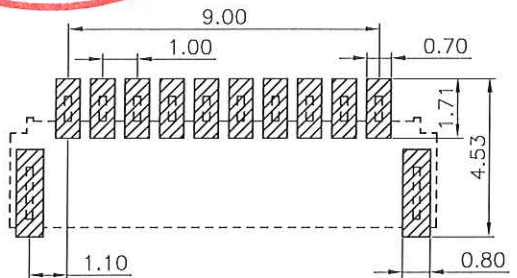
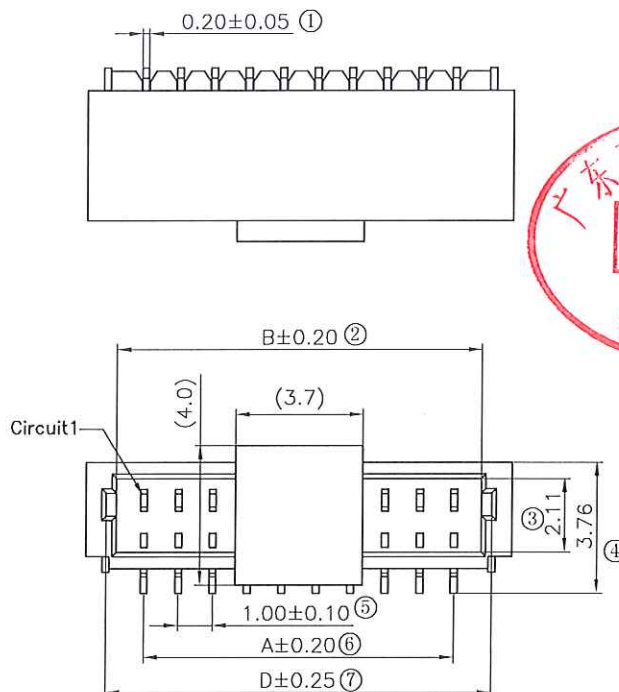

RECOMMENDED PCB LAYOUT
(GENERAL TOLERANCE:±0.05)

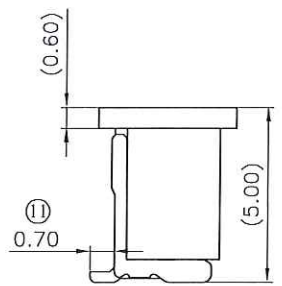
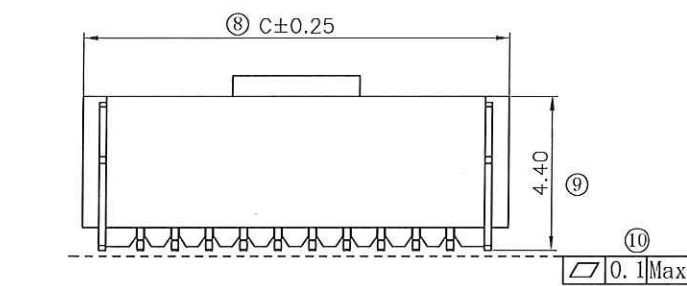

A1 A1002 W 0-1 XX 2 X X 0
 SERIES NO:
 CONNECTOR:
 W-WAFER
 ANGLE:
 0-180°
 ROW NO:
 1-SINGLE ROW
 PIN Q'PY:
 02~20
 COLOR:
 A-BLACK
 S-NATURE
 PLATING:
 A-ALL AU G/F
 C-BRIGHT TIN
 D-MATTE Tin
 TERMPOINT:
 2-SMT

| Circuit | Dimensions(mm) | | | | Circuit | Dimensions(mm) | | | |
|---------|----------------|------|------|------|---------|----------------|------|------|------|
| | A | B | C | D | | A | B | C | D |
| 02P | --- | 2.5 | 4.3 | 3.2 | 12P | 11.0 | 12.6 | 14.3 | 13.2 |
| 03P | 2.0 | 3.6 | 5.3 | 4.2 | 13P | 12.0 | 13.6 | 15.3 | 14.2 |
| 04P | 3.0 | 4.5 | 6.3 | 5.2 | 14P | 13.0 | 14.6 | 16.3 | 15.2 |
| 05P | 4.0 | 5.5 | 7.3 | 6.2 | 15P | 14.0 | 15.6 | 17.3 | 16.2 |
| 06P | 5.0 | 6.5 | 8.3 | 7.2 | 16P | 15.0 | 16.6 | 18.3 | 17.2 |
| 07P | 6.0 | 7.6 | 9.3 | 8.2 | 17P | 16.0 | 17.6 | 19.3 | 18.2 |
| 08P | 7.0 | 8.5 | 10.3 | 9.2 | 18P | 17.0 | 18.6 | 20.3 | 19.2 |
| 09P | 8.0 | 9.6 | 11.3 | 10.2 | 19P | 18.0 | 19.6 | 21.3 | 20.2 |
| 10P | 9.0 | 10.6 | 12.3 | 11.2 | 20P | 19.0 | 20.6 | 22.3 | 21.2 |
| 11P | 10.0 | 11.6 | 13.3 | 12.2 | | | | | |

| REV. | REVISION RECORD | DATE | GENERAL TOLERANCES | SCALE: | NAME | DATE | PART.NO: | DWG.NO: |
|------|---------------------|----------|--------------------|----------|------|-----------|--------------------------------|------------|
| A0 | NEW RELEASE | 21.01.13 | LINEAR | 1:1 | | | A1002W0-1XX2XX0 | ENDE05 |
| A1 | PART NUMBER RENEWAL | | ANGLES | APPROVED | 梁科积 | 2024.5.27 | | |
| | | | 0.0±0.35 | DESIGNER | 梁科积 | 2024.5.27 | TITLE: | |
| | | | X'REF±6' | DRAWN | 符雨曦 | 2024.5.27 | Pitch 1.00mm 180°SH 单排立贴 Wafer | |
| | | | X'±3' | | | | | REV: A1 |
| | | | X'X' ±2' | | | | | SHEET: 1/2 |



WanLian Technology Co., Ltd

The product using material and processing must conform to the "WI-PZ-142"HSF technical standard control requirements

RoHS+HF

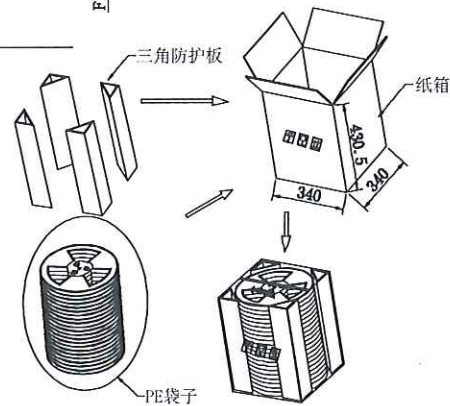
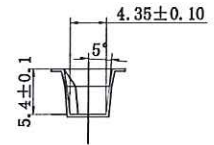
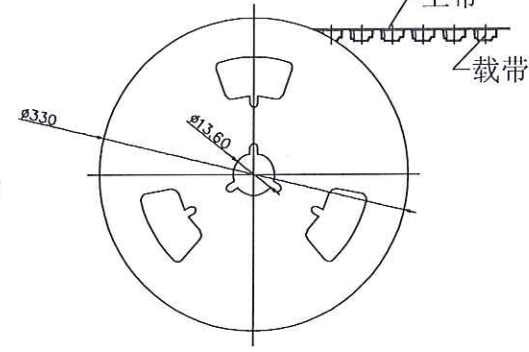
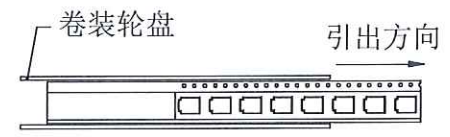
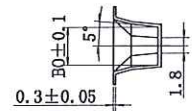
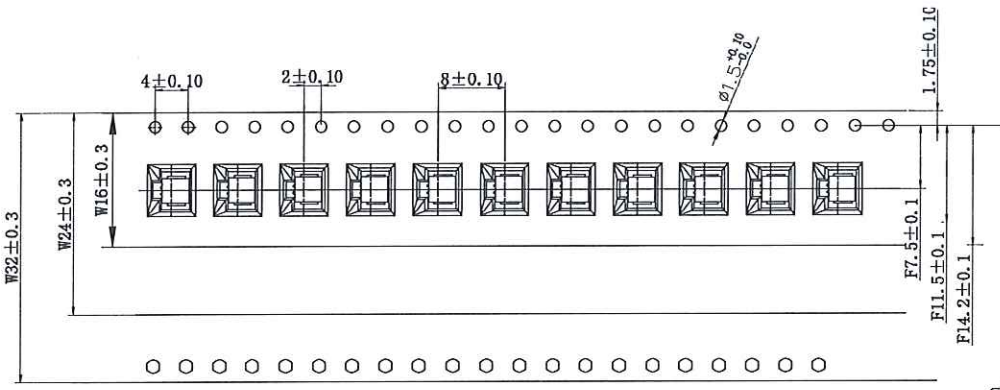

1. 上带剥离力:



| | |
|---|---------------|
| A | 15° ~ 0° |
| F | 20° ~ 70° (g) |

2. 带子预留空格:

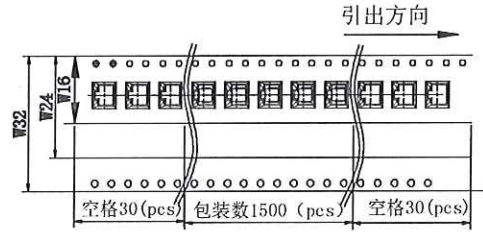

3. 载带材料规格: PS 白色料抗静电, 厚度0.30mm



| Circuits | 载带尺寸 | | | Circuits | 载带尺寸 | | | 卷装包装明细 | | | |
|----------|------|-------|-------|----------|-------|-------|-------|---------|------------|--------|----------|
| | W | BO | F | | W | BO | F | PIN | 每卷包装数 | 每件盘数 | 每件数量 |
| 02P | 16.0 | 4.50 | 7.50 | 12P | 24.00 | 14.50 | 11.50 | 02P-07P | 1500 (PCS) | 20 (盘) | 30 (K) |
| 03P | 16.0 | 5.50 | 7.50 | 13P | 24.00 | 15.50 | 11.50 | 08P-13P | 1500 (PCS) | 14 (盘) | 21 (K) |
| 04P | 16.0 | 6.50 | 7.50 | 14P | 32.00 | 16.50 | 14.20 | 14P-16P | 1500 (PCS) | 11 (盘) | 16.5 (K) |
| 05P | 16.0 | 7.50 | 7.50 | 15P | 32.00 | 17.50 | 14.20 | | | | |
| 06P | 16.0 | 8.50 | 7.50 | 16P | 32.00 | 18.50 | 14.20 | | | | |
| 07P | 24.0 | 9.50 | 11.50 | | | | | | | | |
| 08P | 24.0 | 10.50 | 11.50 | | | | | | | | |
| 09P | 24.0 | 11.50 | 11.50 | | | | | | | | |
| 10P | 24.0 | 12.50 | 11.50 | | | | | | | | |
| 11P | 24.0 | 13.50 | 11.50 | | | | | | | | |

| REV. | REVISION RECORD | DATE | UNIT:mm | GENERAL TOLERANCES | | SCALE: | NAME | DATE | PART.NO: | DWG.NO: | WanLian Technology Co., Ltd |
|------|---------------------|----------|----------|--------------------|----------|----------|----------|-----------|----------|---------|-----------------------------|
| A0 | NEW RELEASE | 21.01.13 | | 0.00±0.25 | X'±3' | 1:1 | APPROVED | | | | |
| A1 | PART NUMBER RENEWAL | | SIZE: A4 | 0.00±0.10 | X'X' ±2' | DESIGNER | 梁祥秋 | 2024.5.27 | TITLE: | REV: A1 | SHEET: 2/2 |
| | | | | | | DRAWN | 高南顺 | 2024.5.27 | | | |