

1 2 3 4 5 6 7 8

A
B
C
D
E
F
G
H

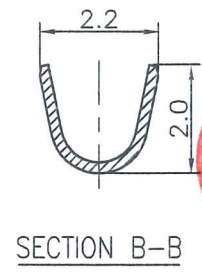
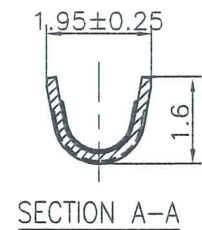
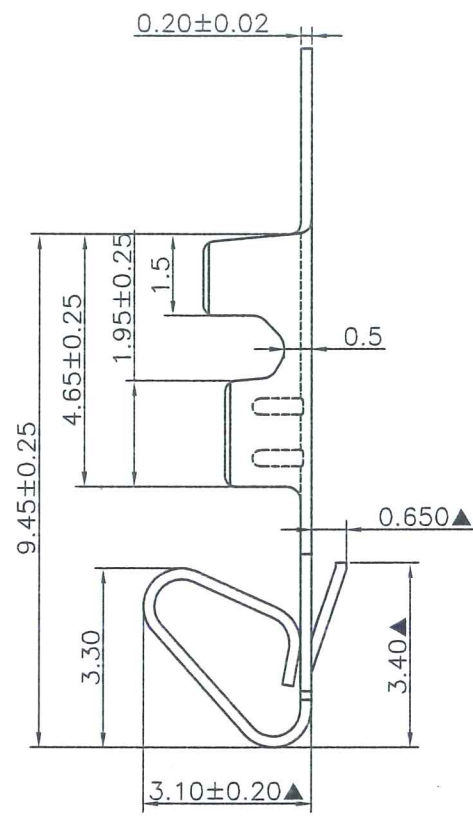
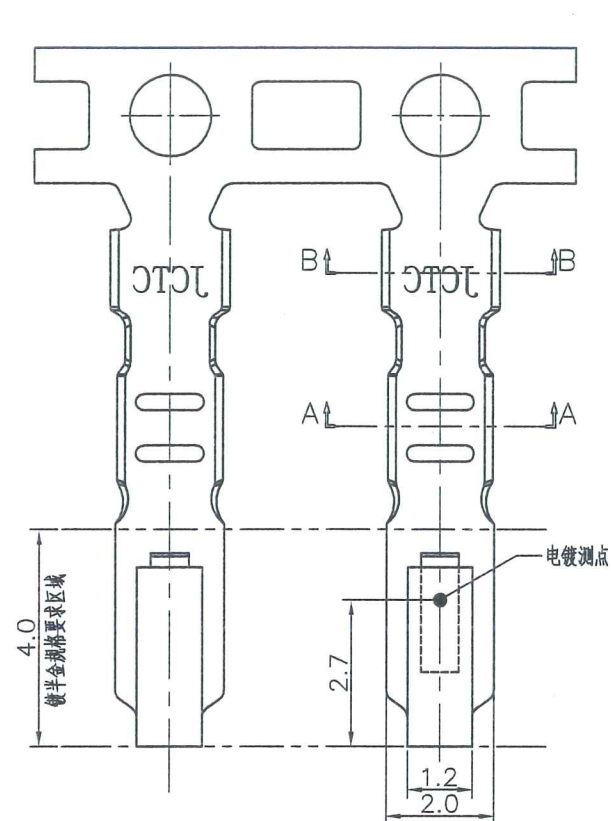

12543 I O P - XX
① ②③④ ⑤

- ① Series No.
- ② T: Terminal
- ③ 9 : Side Contact
0 : Up Contact
- ④ P : Phosphor Bronze
- ⑤ XX: Finish
2 : Tin-plated(先镀后冲)
2E : Tin-plated(先冲后镀)

The product using material and processing must conform to the "WI-PZ-142"HSF technical standard control requirements

Part No	Wire Range	Insulation O.D.	Material	Finish	Qty/reel
12543TOP-2	AWG #22~#28	1.70mm(max)	Phosphor Bronze	Tin-plated	8,000 pcs
12543TOP-2E	AWG #22~#28	1.70mm(max)	Phosphor Bronze	Tin-plated	8,000 pcs
12543TOP-3E	AWG #22~#28	1.70mm(max)	Phosphor Bronze	Matte Tin plated	8,000 pcs
12543TOP-0A	AWG #22~#28	1.70mm(max)	Phosphor Bronze	Gold-flash	8,000 pcs
12543TOP-0B	AWG #22~#28	1.70mm(max)	Phosphor Bronze	2u" Au	8,000 pcs
12543TOP-0C	AWG #22~#28	1.70mm(max)	Phosphor Bronze	3u" Au	8,000 pcs
12543TOP-0G	AWG #22~#28	1.70mm(max)	Phosphor Bronze	15u" Au	8,000 pcs
12543TOP-0H	AWG #22~#28	1.70mm(max)	Phosphor Bronze	30u" Au	8,000 pcs

REV.	REVISION RECORD	DATE	GENERAL TOLERANCES		SCALE	NAME	DATE	PART NO.	DWG NO.	JCTC® TERMINAL&CONNECTORS			
C6	新"OG"规格	14.08.11		LINEAR	1:1	Nelson	22-01-06	12543TOP-XX	ENDE05				
D0	更新公司名称	17.01.10		0.0±0.25									
D1	新"OH"规格	19.12.23	UNIT: MM	0.00±0.15	X° ±3°	VM	22.01.06	TITLE	2510 端子				
D2	依PBJOA202201100001新增规格	22.01.06		SIZE: A4									

1 2 3 4 5 6 7 8

A
B
C
D
E
F
G
H

REV D2 SHEET 1/1